

KEY NOTES

- 1 EXISTING PLYWOOD BACKBOARD.
- 2 NEW PLYWOOD BACKBOARD FOR INTRUSION AND CARD ACCESS EQUIPMENT.
- 3 NEW 4-POST FULLY ENCLOSED VOICE/DATA, CCTV, AND OVERHEAD PAGING CABINET.
- 4 NEW ACCESS CONTROL PANEL.
- 5 NEW INTRUSION CONTROL PANEL.

GENERAL NOTES

- A. INSTALL CONDUIT WITH NO MORE THAN TWO (2) 90° BENDS BETWEEN PULL BOXES, AND NO MORE THAN 100'-0" (30m) / 30m (100'-0") BETWEEN PULL BOXES. PULL BOXES SHALL BE INSTALLED FOR STRAIGHT THRU PULLS ONLY.
- B. PROVIDE COMPLETE CARD ACCESS SYSTEM, HOMERUN CONDUIT AND CABLE BACK TO BASEMENT PLYWOOD BACKBOARD. PROVIDE CONDUITS IN WALLS AND EXPOSED CEILING AREAS, AND J-HOOKS ABOVE T-BAR CEILING AREAS.
- C. PROVIDE COMPLETE CCTV SYSTEM, HOMERUN CONDUIT AND CABLE BACK TO BASEMENT SYSTEMS CABINET. PROVIDE CONDUITS IN WALLS AND EXPOSED CEILING AREAS, AND J-HOOKS ABOVE T-BAR CEILING AREAS.
- D. PROVIDE COMPLETE PA SYSTEM, HOMERUN CONDUIT AND CABLE BACK TO BASEMENT SYSTEMS CABINET. PROVIDE CONDUITS IN WALLS AND EXPOSED CEILING AREAS, AND J-HOOKS ABOVE T-BAR CEILING AREAS.
- E. HOMERUN ALL NEW INTRUSION CABLING FOR DEVICES BACK TO NEW INTRUSION PANEL LOCATED IN THE BASEMENT ON PLYWOOD BACKBOARD. PROVIDE CONDUITS IN WALLS AND EXPOSED CEILING AREAS, AND J-HOOKS ABOVE T-BAR CEILING AREAS.
- F. ALL VOICE/DATA, CCTV, INTRUSION, AND OVERHEAD PAGING CABLING SHALL BE FT6 RATED.

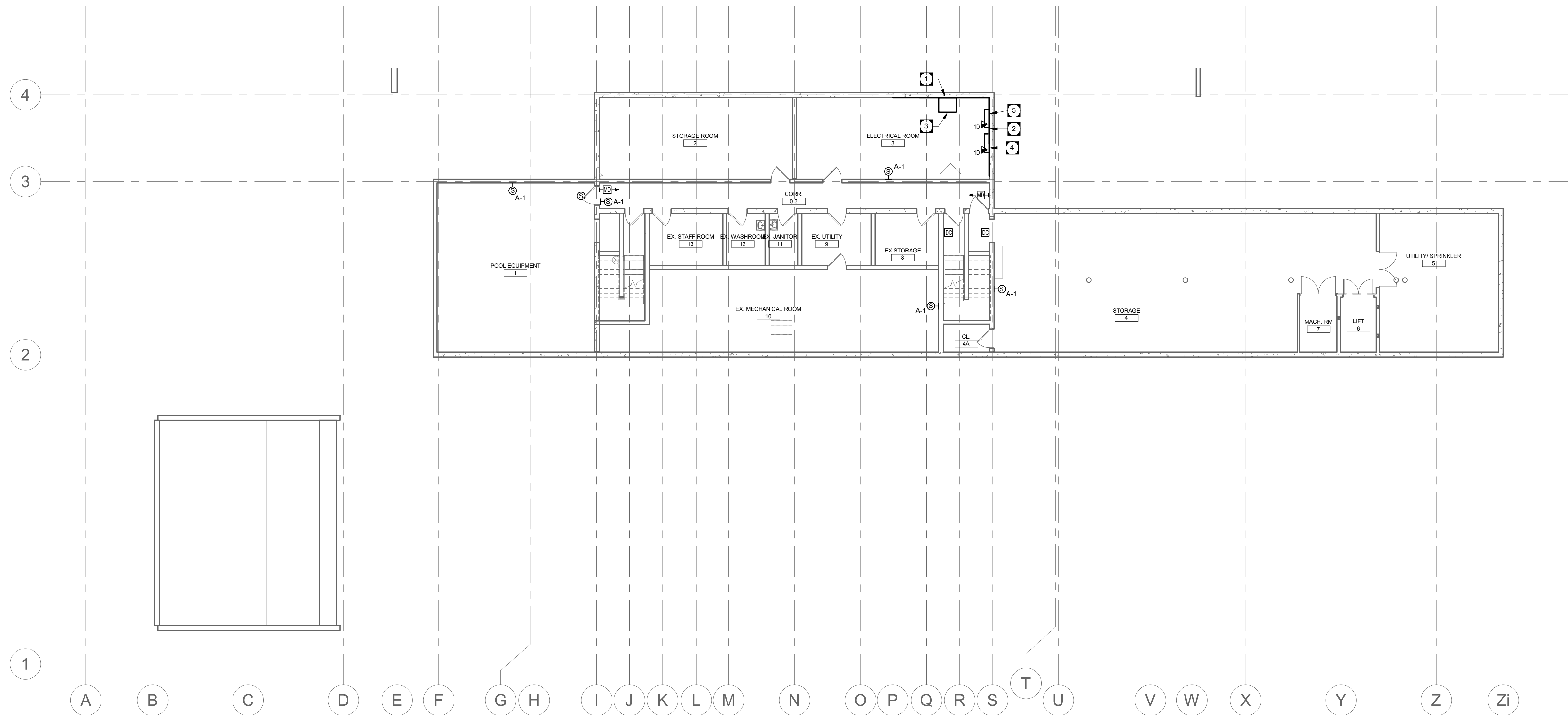

LEVEL 0 - SYSTEMS RENOVATION 1
3/32" = 1'-0" ES2.0



Certificate of Authorization
Epp Siepmann Engineering Inc.
No. 4035

This is a print of a document that has been electronically authenticated with technology authorized by the APEGM. The original is in electronic form.

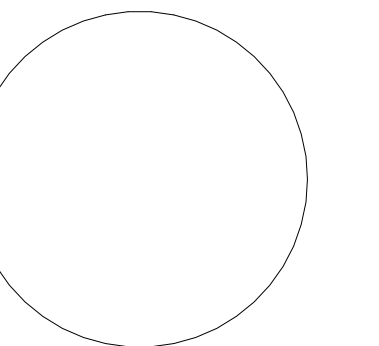

This drawing must not be scaled. The contractor shall verify all dimensions and other data on site prior to commencement of work. Discrepancies, errors, and omissions are to be reported to Public City Architecture Inc. prior to proceeding with the Work.

Drawings and specifications as instruments of service are the property of Public City Architecture Inc. the copyright in the same being reserved.

No reproduction or revision to these drawings may be made without the permission of Public City Architecture Inc. and when made, must bear their name. All prints to be returned to Public City Architecture Inc. upon request.

Project
ST. JAMES CIVIC CENTRE

Drawing
BASEMENT RENOVATION -
SYSTEMS PLAN

Drawn By:	Review By:
JP	MP
Scale:	Tender No:
As indicated	1176-2019
Date:	11/06/19
Sheet:	ES2.0